

Garden Park Clubhouse

Rental Information Quick Fact Sheet

1. Contact the Daybreak Community Association front desk for any questions about reservations at 801-254-8062. To complete the reservation, please visit the office at 11274 S. Kestrel Rise Rd. Suite F, South Jordan, UT 84009. (See item 3)
2. Reservations are taken up to six months in advance, and no sooner than 30 days in advance.
3. Your date is secured once you have paid a refundable deposit and signed the contract.
4. Rental fees are due no later than 30 days in advance.
5. The rental includes the use of the rented rooms (A and/or B), 6 round tables, 3 rectangular tables, and chairs (amount depending on which room you rent, 70 maximum). The rental also covers use of the covered patio area behind the wooden pillars. It does not include any other area of the clubhouse, which will remain available for the residents of Garden Park to use during your event should they choose.
6. Your rental time must include time to set up, take down, and clean up. If your event goes over on time it will be held from your deposit.
7. Let us know at the time you schedule your rental if you will be using any vendors (caterers, equipment rental companies, etc.), as the clubhouse has special requirements for companies that work on the property.
8. Let us know if you plan to serve alcohol during your event, as there are requirements that must be met to do so.
9. Your deposit does get cashed, however if you have sufficiently cleaned the area, put away all tables and chairs, not caused any damage, not gone over on time, etc. it will be refunded to you. You will receive a check in the mail, usually within 14 business days of the event.
10. The Daybreak resident must be at the event during the entire event. They must check in with the staff member at the beginning of the reservation time and check out at the end after clean up.

PRICING

ROOM A

- MAXIMUM OCCUPANCY: 80
- INCLUDES COVERED PATIO AREA ONLY BEHIND WOODEN PILLARS
- \$250 REFUNDABLE DEPOSIT DUE AT TIME OF RESERVATION (DEPOSIT CHECK IS CASHED)
- RENTAL RATE: \$160 FOR THE FIRST 3 HOURS, \$120 FOR EACH ADDITIONAL HOUR

ROOM B

- MAXIMUM OCCUPANCY: 20
- INCLUDES THE WARMING KITCHEN AND COVERED PATIO AREA ONLY BEHIND WOODEN PILLARS
- \$250 REFUNDABLE DEPOSIT DUE AT TIME OF RESERVATION (DEPOSIT CHECK IS CASHED)
- RENTAL RATE: \$160 FOR THE FIRST 3 HOURS, \$120 FOR EACH ADDITIONAL HOUR

ROOMS A & B

- MAXIMUM OCCUPANCY: 100
- INCLUDES WARMING KITCHEN AND COVERED PATIO AREA ONLY BEHIND WOODEN PILLARS
- \$500 REFUNDABLE DEPOSIT DUE AT TIME OF RESERVATION (DEPOSIT CHECK IS CASHED)
- RENTAL RATE: \$210 FOR THE FIRST THREE HOURS, \$170 FOR EACH ADDITIONAL HOUR

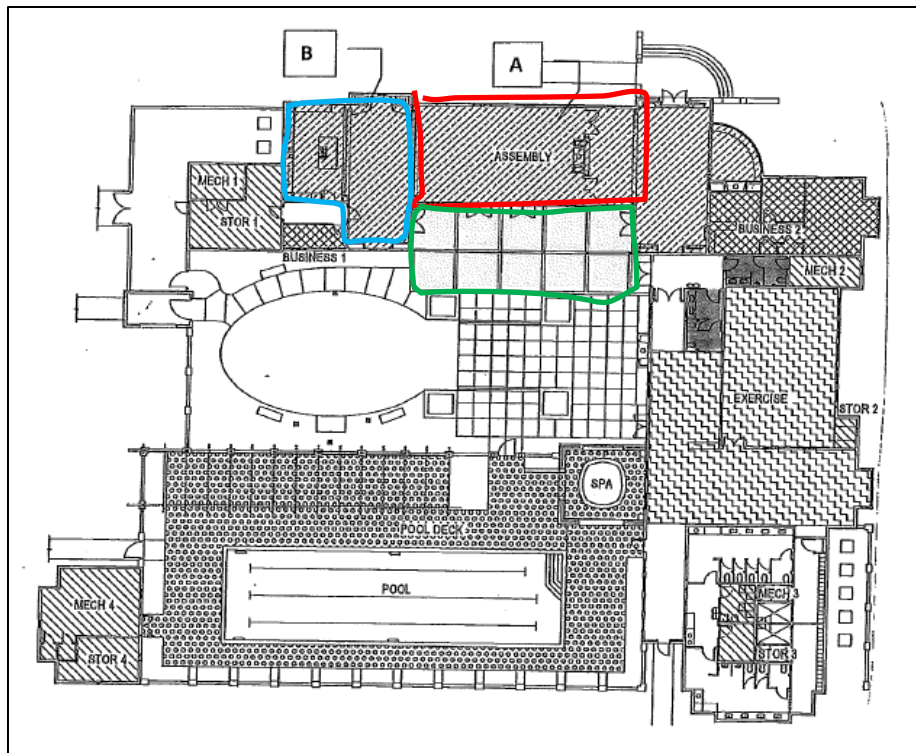

Garden Park Resident Discount

- Rooms A&B (Together): \$50 off the first three hours, \$50 off each additional hour.
- Room A OR B (individually): \$25 off the first three hours, \$25 off each additional hour.